

**EXTENDA-LITE 12V2 ST SERIES LIGHT HEADS
COMPLETE HD-12V2-ST HEAD ASSEMBLY**

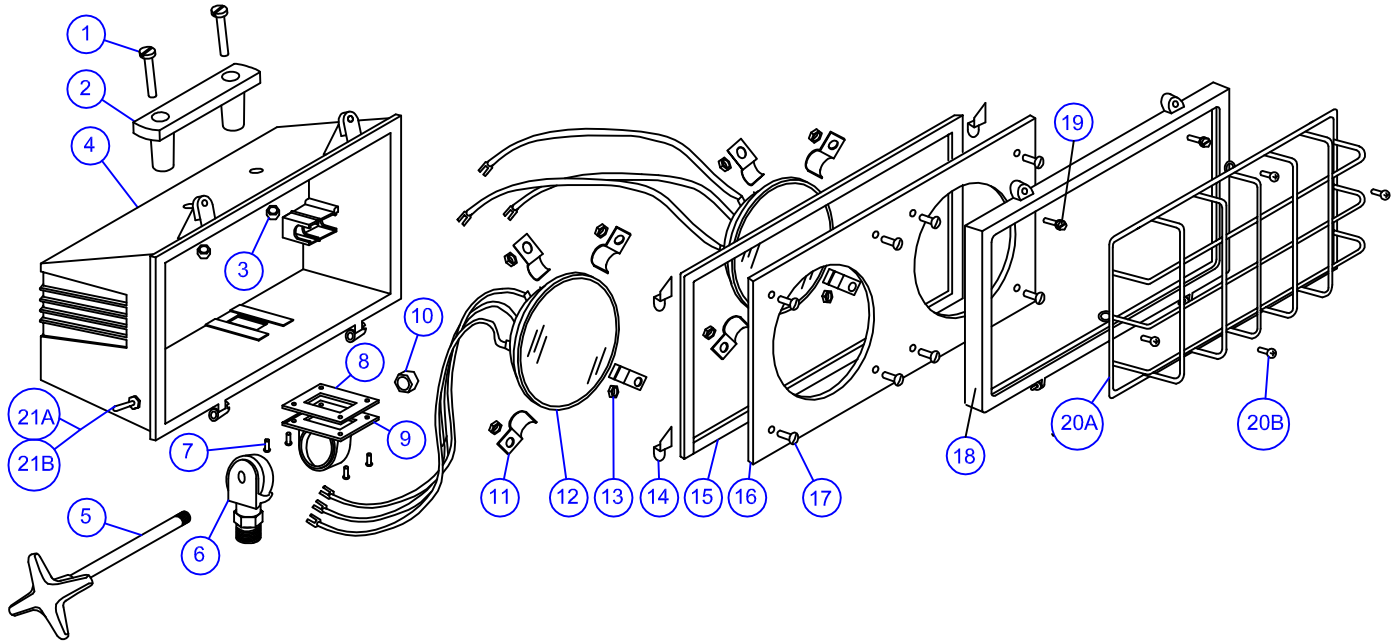

PARTS LIST				
NO.	ASSY. NO.	PART NO.	DESCRIPTION	QTY.
1		317-HS	HANDLE SCREW	2
2	300-SH	301-SH		
3		318-HN		
4		560-HG	1500 ST HOUSING	1
5		KBT-15	KNOB ASSEMBLY	1
10		321-LN	KNOB ASSEMBLY NUT	1
6		555-HS	3/4" HOUSING ARM	1
7		474-AO	ADAPTER SCREW	4
8		324-GA	ADAPTER GASKET	1
9		564-HA	HOUSING ARM ADAPT.	1
11		115-LC	LIGHT HEAD CLAMP	8
12		4007	12 VOLT LAMP	2
13		632-NT	CLAMP NUT	8

PARTS LIST				
NO.	ASSY. NO.	PART NO.	DESCRIPTION	QTY.
14		554-LC	LENS CLIP	4
15		550-GA	FACEPLATE GASKET	1
16		12V2-ST	DUAL 12V FACEPLATE**	1
17		632-SC	FACEPLATE SCREW	8
18		330-FR	LENS FRAME	1
19		566-LS	LENS FRAME SCREW	2
20A	WG-4	331-WG	WIRE GUARD	1
20B		343-GS		
21A	SW-12V	346-SW	SWITCH- ON-OFF-ON	1
21B		345-SB		

} THESE PARTS SOLD AS ASSEMBLIES

**PART NUMBER ABBREVIATED. FULL PART NUMBER IS 12V2-STONCO.

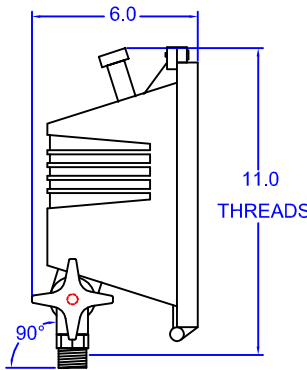
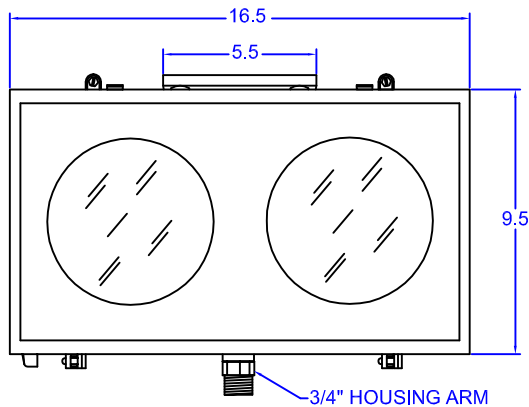

REV 07/14

ISO-9001 CERTIFIED



Akron Brass Company
A Premier Farnell Company

501 N. Cummings Lane, Washington, IL 61571
Phone: (309)444-4440 Fax: (309)444-8766