

PORT DIAGRAMS

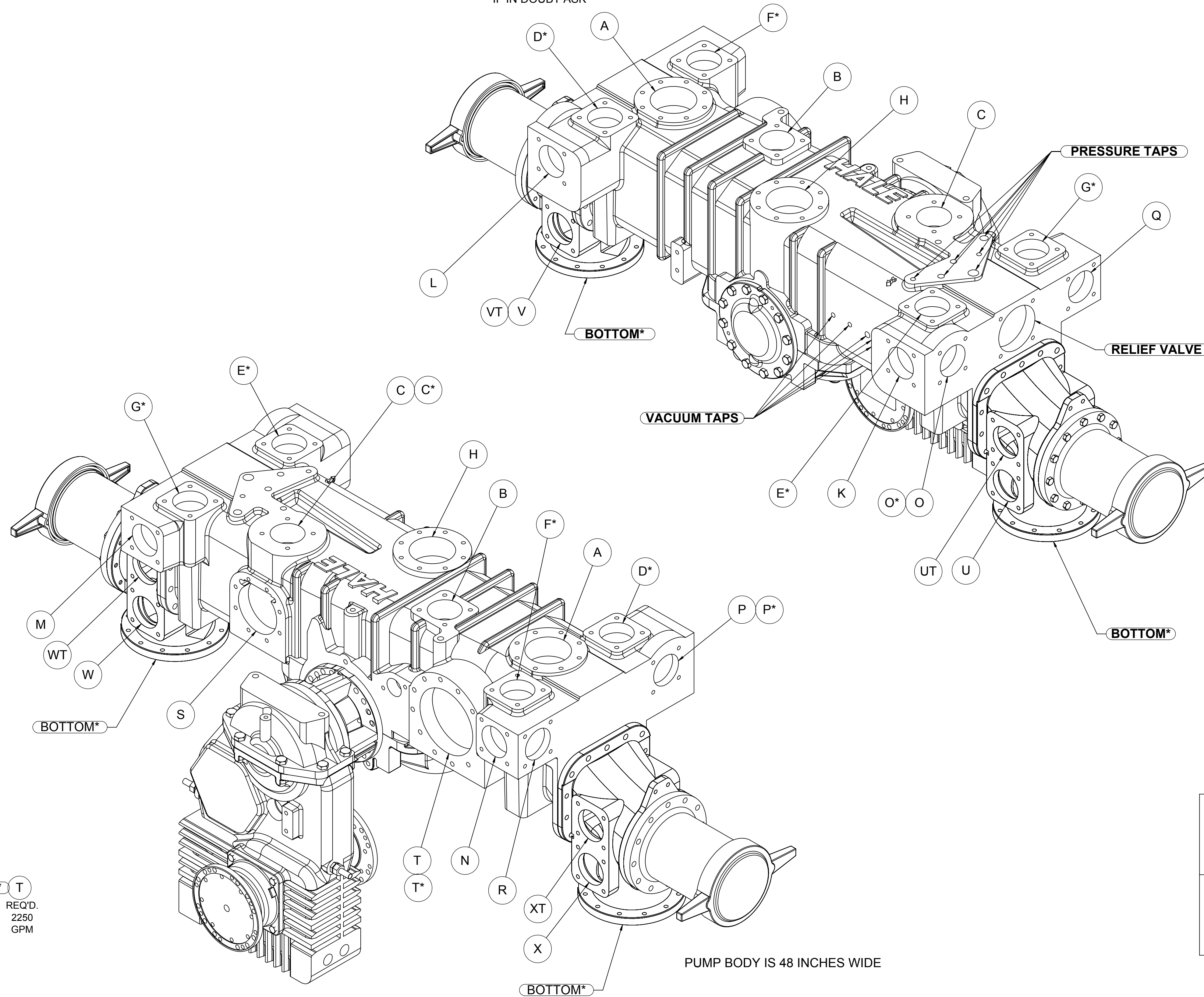

IF IN DOUBT ASK

PROJECTION:



PORT BOLT PATTERN DIAGRAMS
* DENOTES OPTIONAL BOLT PATTERN

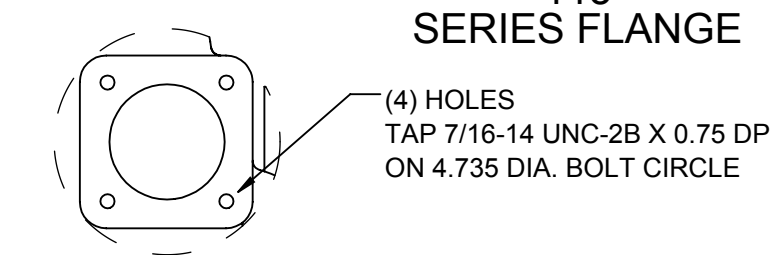
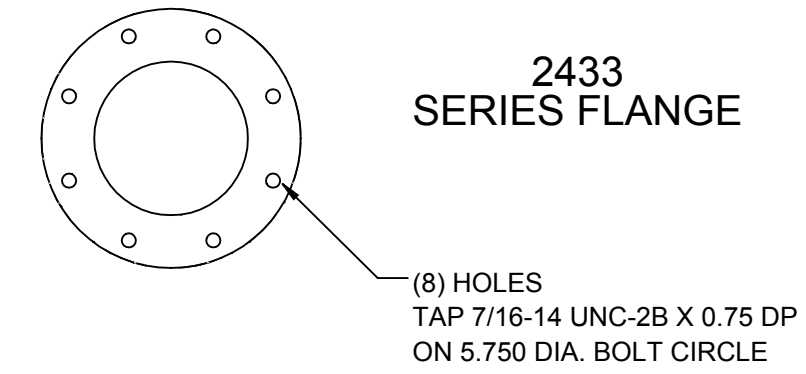
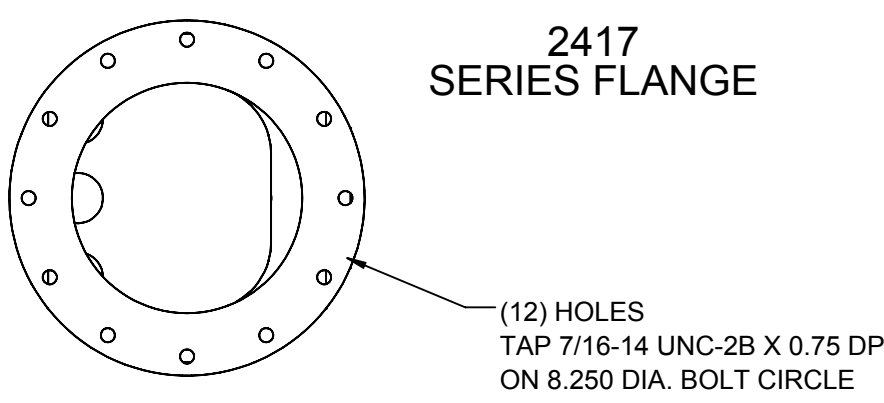
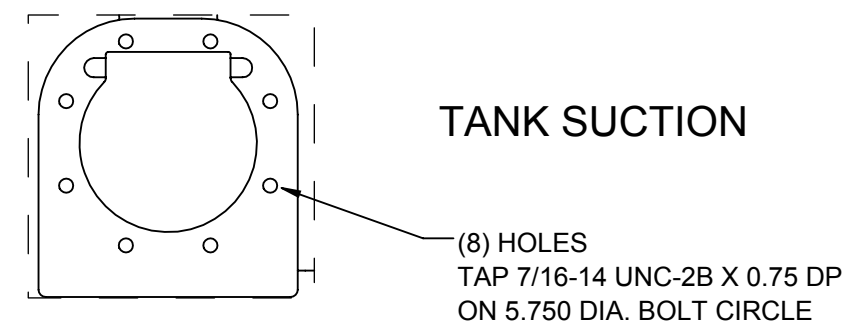

S T*

BOTTOM* T
REQ'D.
2250
GPM

A C* H O* P*

B D* F* K M O Q U UT
W WT C E* G* L N
P R V VT X XT

LEFT SIDE SUCTION
EXTENSION: _____
MIV: _____
TUBE: _____
CAP: _____

RIGHT SIDE SUCTION
EXTENSION: _____
MIV: _____
TUBE: _____
CAP: _____

PUMP BODY IS 48 INCHES WIDE

PRESSURE TAPS
(1) 3/4" - 14 NPT
(1) 1/2" - 14 NPT
(2) 3/8" - 18 NPT
(2) 1/4" - 18 NPT
VACUUM TAPS
(1) 3/4" - 14 NPT
(1) 1/2" - 14 NPT
(1) 3/8" - 18 NPT
(2) 1/4" - 18 NPT

UNLESS OTHERWISE SPECIFIED
DIMENSIONS ARE IN MILLIMETERS
[INCHES ARE FOR REFERENCE, ONLY]
TOLERANCE FOR MILLIMETER DIMENSIONS:
X: ±1
X.X: ±0.5
X.XX: ±0.25
X.XXX: ±0.125
ANGLES: ±0.25°
SURFACE TEXTURE IN µm Ra
REMOVE ALL SHARP EDGES, 0.25MAX

COPYRIGHT ©
NOT TO BE REPRODUCED OR USED TO
MAKE OTHER DRAWINGS OR MACHINERY

FSG OF IDEX IDEX CORPORATION		HALE GODIVA Class 1	
MATERIAL	TITLE		
MADE FROM	DRAWN		
FINISH	APPROVED	SIZE D	DRAWING NUMBER
PROJECT	DATE	SCALE 1:10	REV
QMax Port Diagram			SHEET 1 OF 1