

THIS DRAWING AND ALL INFORMATION CONTAINED HEREIN IS THE PROPERTY OF WELDON TECHNOLOGIES, INC. AND MAY NOT BE COPIED, REPRODUCED, OR DEVULGED TO UNAUTHORIZED PERSONS WITHOUT THE EXPRESS WRITTEN CONSENT OF WELDON TECHNOLOGIES, INC. AS IT IS BEING PROVIDED SOLELY FOR THE CONVENIENCE OF THE USER AND SHALL BE RETURNED TO WELDON TECHNOLOGIES, INC. UPON REQUEST.

REVISIONS				
REV.	ECN	DESCRIPTION	DATE	BY / APVD
A	R0965	RELEASE FOR PRODUCTION	9/6/11	TB

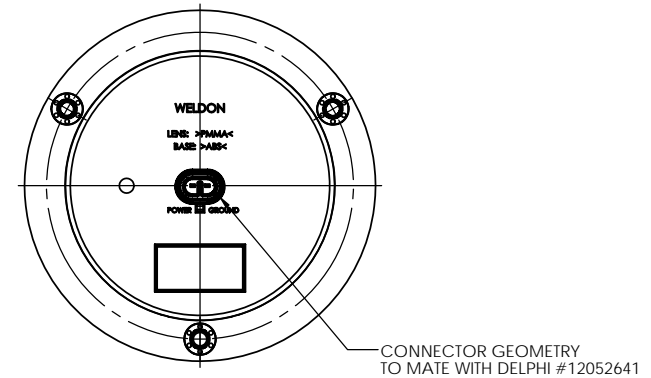

- NOTES:
1. LENS MATERIAL: ACRYLIC (PMMA). MATERIAL MEETS SAE J576.
BASE MATERIAL: ABS.
 2. MATING LAMP CONNECTOR TO BE DELPHI #12052641.
TERMINAL TO BE:
20-22 AWG WIRE = DELPHI #12084200
16-20 AWG WIRE = DELPHI #12048074
CABLE SEAL TO BE:
CABLE DIAMETER 1.60-2.15 = DELPHI #12089678
CABLE DIAMETER 2.03-2.85 = DELPHI #12048086
SECONDARY LOCK TO BE DELPHI #12052634
 3. OPERATING VOLTAGE RANGE = 9.0-18.0 VDC.
 4. LAMP CURRENT TO BE: "A" = POWER, "B" = GROUND
MIN. (9.0VDC) TYP. (14.0VDC) MAX. (18.0VDC)
70mA 200mA 300mA
 5. OPERATING TEMPERATURE RANGE = -40C TO +65C

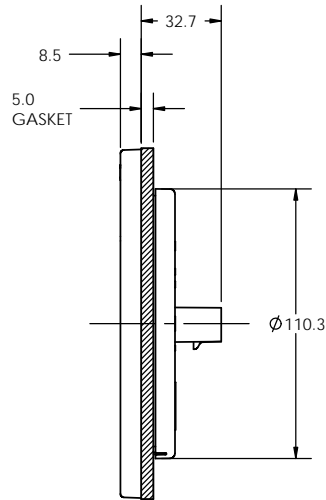
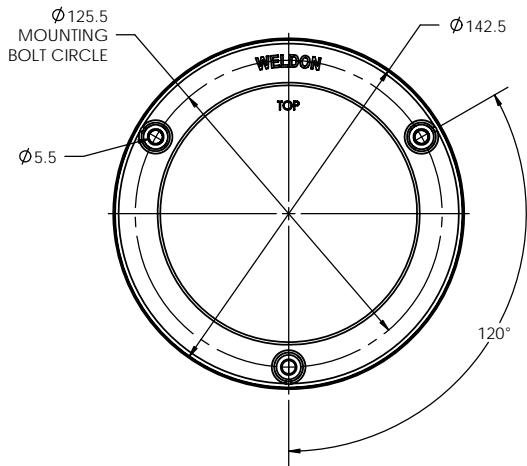
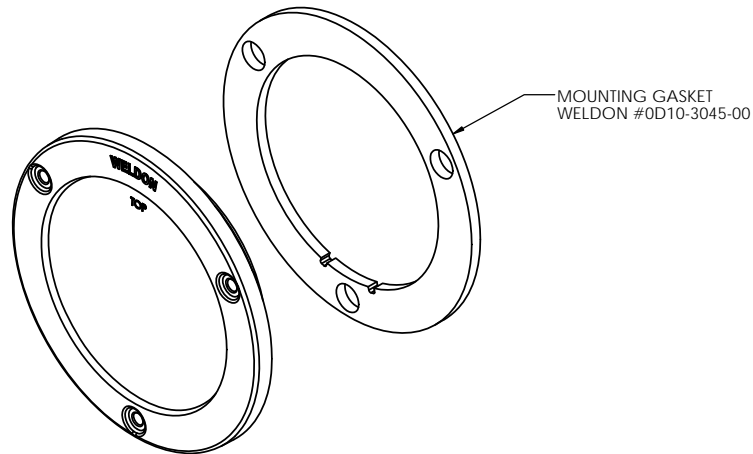

UNLESS OTHERWISE SPECIFIED, DIMENSIONS ARE IN mm. TOLERANCES ARE:		CAD GENERATED DRAWING. DO NOT MANUALLY UPDATE		WELDON TECHNOLOGIES, INC.	
X.XX - ± 0.15		APPROVALS		DATE	
X.X - ± 0.5		DRAWN		5/20/11	
ANGLES - $\pm 0.5^\circ$		CHECKED			
MATERIAL		QUAL ENG			
FINISH		MFG ENG			
DO NOT SCALE DRAWING		PROJ. NO.		--	
		SIZE		PART NO.	
		B		C8270-0100-30	
		SCALE:		WELDON COMPUTER GRAPHICS	
				SHEET 1 OF 1	